



CHATTERTON | REES



17a Ashburnham Road

, London, SW10 0PG

Asking price £550,000



1



1

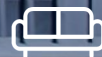

1



C

17a Ashburnham Road



Description

A sensible lower ground floor, one bedroom flat with a private south facing garden approached via the kitchen. The flat has made an excellent home and then rental investment for our client and has a generous reception room and a good sized bedroom with a bathroom. It also has a lapsed planning permission to go into the garden and make the property a 2 bedroom.

Ashburnham Road is in the heart of Lots Village Conservation Area and is well situated to benefit from the exciting new Chelsea Waterfront Development. The Kings Road is nearby with a wonderful array of shops, bars and restaurants. Excellent transport links can be found nearby including multiple bus routes as well as Imperial Wharf Rail Station and Fulham Broadway (District Line). Westfield Park is moments away and offers an area for dogs and a children's playground.

- Bedroom
- Reception Room
- Garden
- Bathroom
- Kitchen
- EPC Rating C





Floor Plan

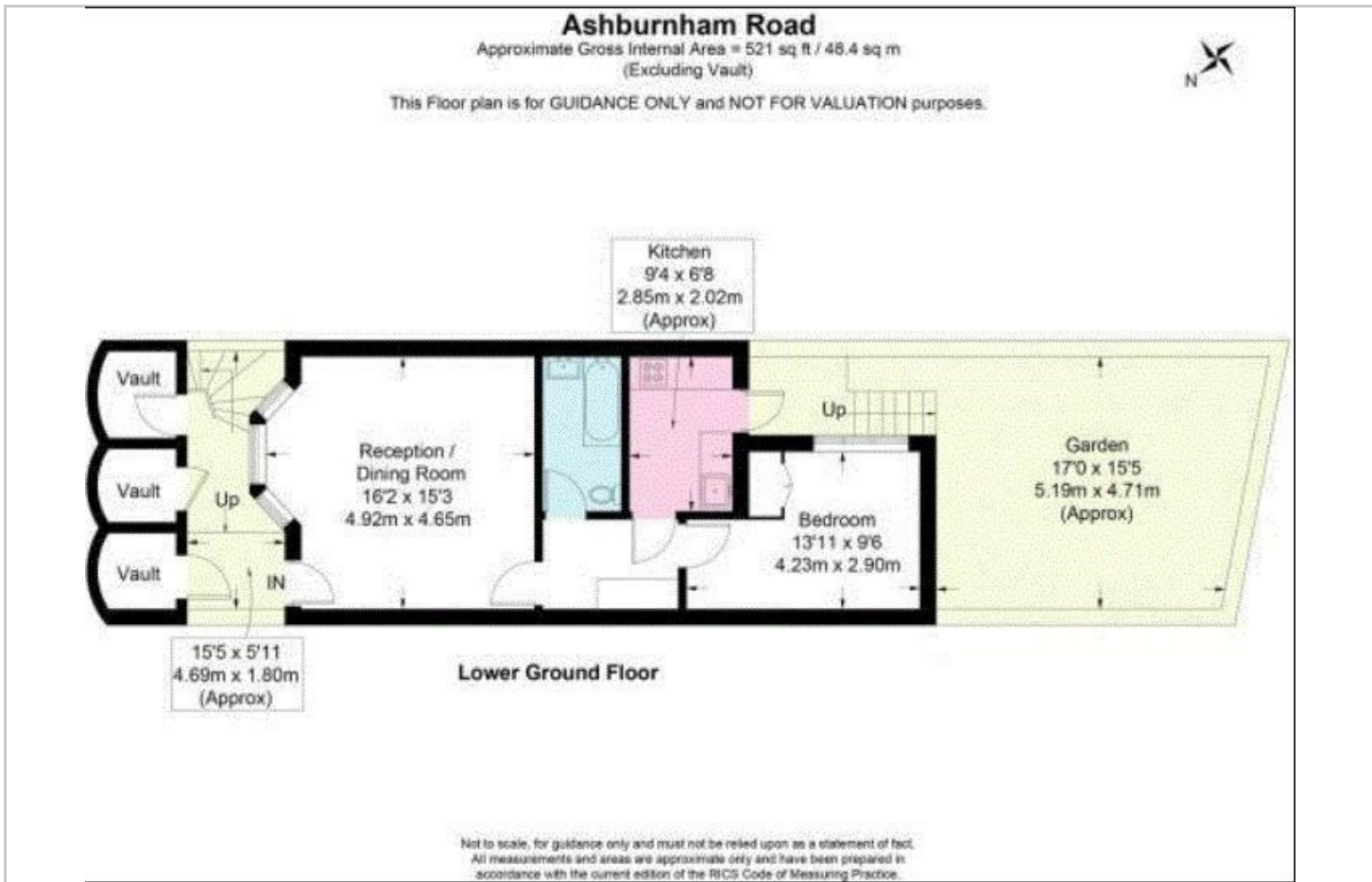

Area Map

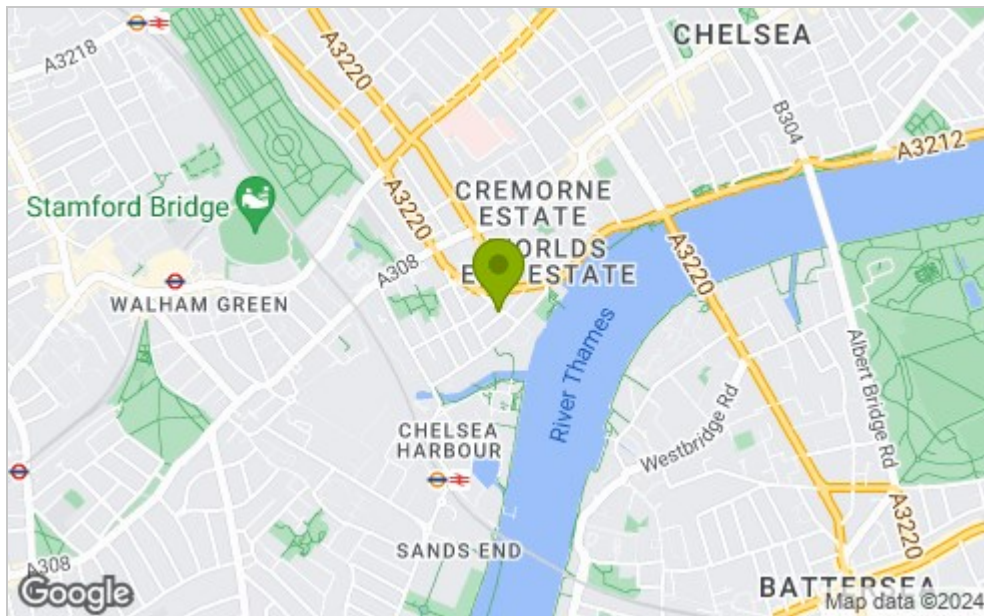

Viewing

Please contact our Chatterton Rees Office on 020 3780 0580 if you wish to arrange a viewing appointment for this property or require further information.

These particulars, whilst believed to be accurate are set out as a general outline only for guidance and do not constitute any part of an offer or contract. Intending purchasers should not rely on them as statements of representation of fact, but must satisfy themselves by inspection or otherwise as to their accuracy. No person in this firm's employment has the authority to make or give any representation or warranty in respect of the property.

Energy Efficiency Graph

